

# Sockets and accessories

## GZF80

For RM84, RM85, RM85 inrush, RM85 105 °C sensitive, RM87L, RM87L sensitive, RM87P, RM87P sensitive, RMP84, RMP85

Screw terminals  
Max. tightening moment for the terminal: 0,5 Nm  
35 mm rail mount acc. to EN 60715 or on panel mounting  
67,2 x 15,5 x 36,5 mm  
Two poles, 5 mm pinout 10 A, 250 V AC



### Connection diagrams ④

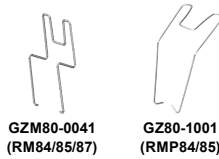
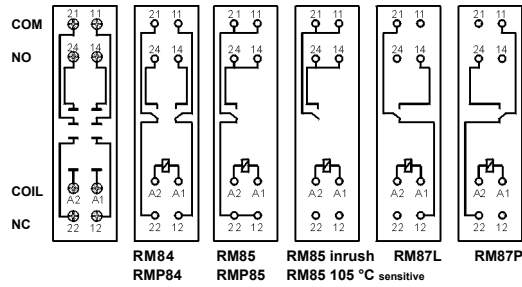

### Dimensions

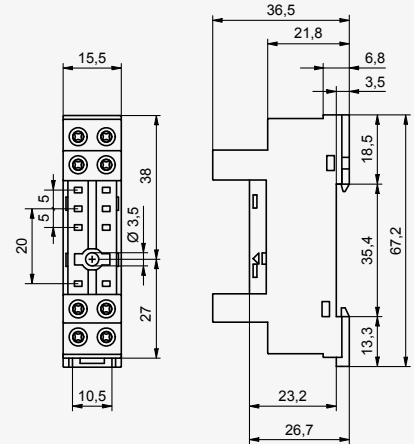

### Accessories

## GZP80

For RM84, RM85, RM85 inrush, RM85 105 °C sensitive, RM87L, RM87L sensitive, RM87P, RM87P sensitive, RMP84, RMP85

Push-in terminals (flammability class V-0)  
Max. cross section of the cables: 2 x 1,5 mm<sup>2</sup> (ferrules without insulation) 2 x 1 mm<sup>2</sup> (ferrules with insulation)  
Stripping length: 8...10 mm

35 mm rail mount acc. to EN 60715 or on panel mounting  
97 x 15,9 x 45,9(75,8) mm ②  
5 mm pinout  
One pole 12 A, 300 V AC  
Two poles 8 A, 300 V AC



Module type M...



ZGP80-8



### Accessories ①

### Dimensions

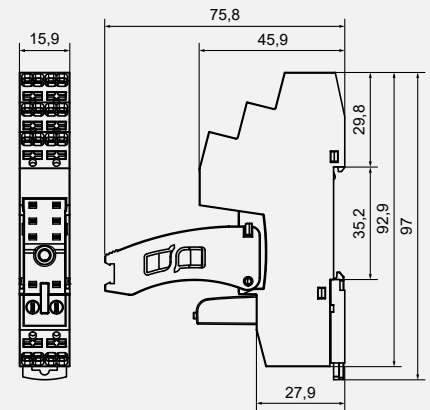

The drawings present inserting wire into the Push-in terminal and removing wire using the button releasing a clamp (assembly without tools).

### Wire connection

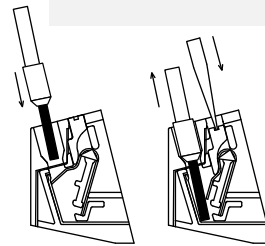

## PW80

For RM84, RM85, RM85 inrush, RM85 105 °C sensitive, RM87L, RM87L sensitive, RM87P, RM87P sensitive, RM83

For PCB  
34,6 x 12,9 x 6,6 mm  
Two poles, 5 mm pinout 12 A, 250 V AC



### Pinout

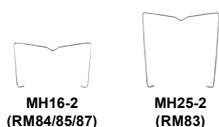
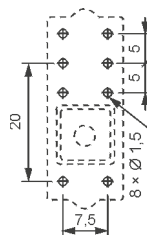

### Accessories

### Dimensions

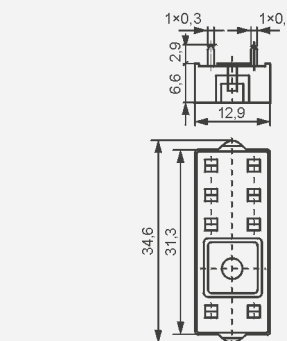

① Mounting and sub-assemblies of accessories in the socket; Signalling / protecting modules type M... - see [www.repol.com.pl](http://www.repol.com.pl) ② In the bracket the height of socket with retainer / retractor clip is shown. ④ For RM85..., RMP85: loads above 12 A (GZT80, GZM80, GZP80) or 10 A (GZS80, GZF80) require bridging pairs of terminals: 11 with 21, 12 with 22, 14 with 24 - see [www.repol.com.pl](http://www.repol.com.pl)